

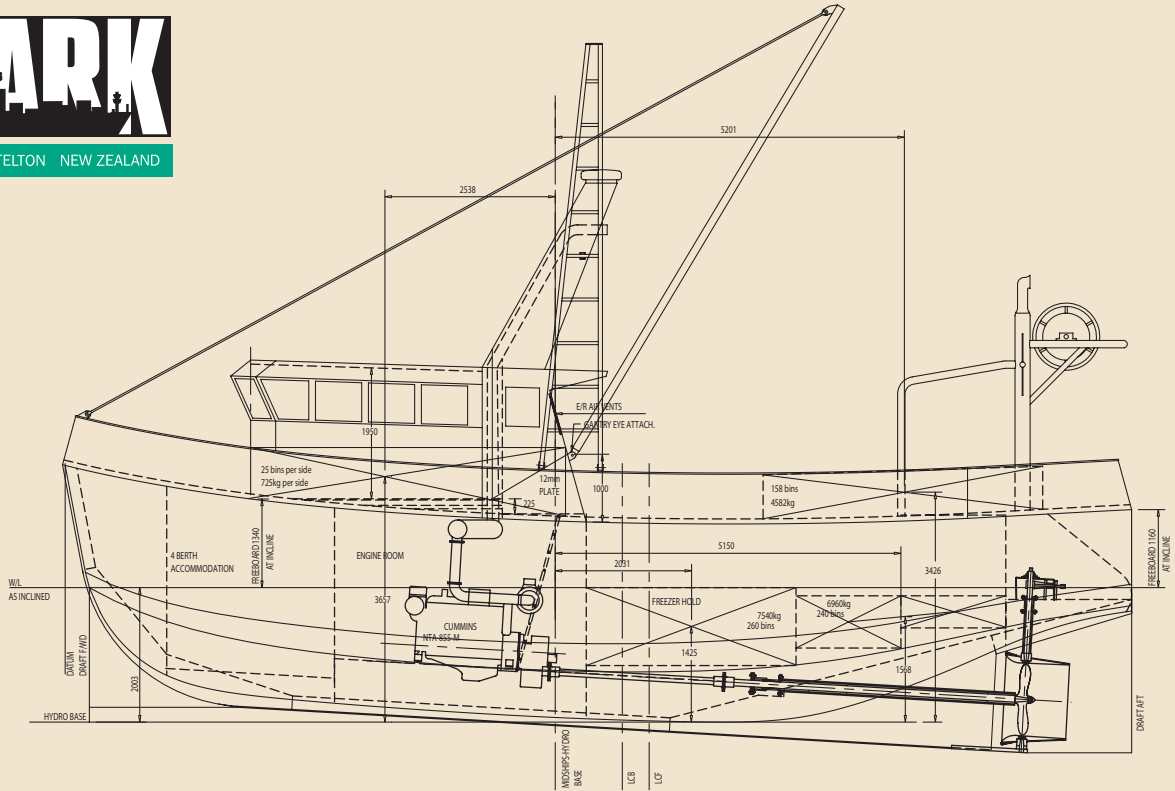

BROS LTD LYTTELTON NEW ZEALAND



SB-ST16 steel trawler

This Steel Stern Trawler 16m was designed and built as the FT Cressy — launched December 1996. Known as a “BIG Little Boat” it has been a top performer since launching, easily eclipsing the catch rates of anything it’s size and even pushing significantly larger vessels.

Designed specifically to fish the grounds based out of Lyttelton, New Zealand, this vessel has proven to be economical, reliable, and as a result very profitable. The vessel has operated in a range of fishing areas, from traditional inshore “market” fishing through to fisheries such as Hoki (including the notorious Cook Strait) Red Cod and Blue Warehou. It has proven itself very capable in both mid-water and bottom trawling, and with a range of electronics fitted has been able to perform at times when other vessels are finding the fishing hard going.

Net Rollers and Trawl Winch Configuration ensure that this vessel can easily adapt to the conditions, changing Mid Water or Bottom Trawl nets as and when required. Designed to operate with a Skipper and 2 crew, this vessel has accommodation for Skipper and 3 crew enabling additional crew / observers to be carried as may be required.

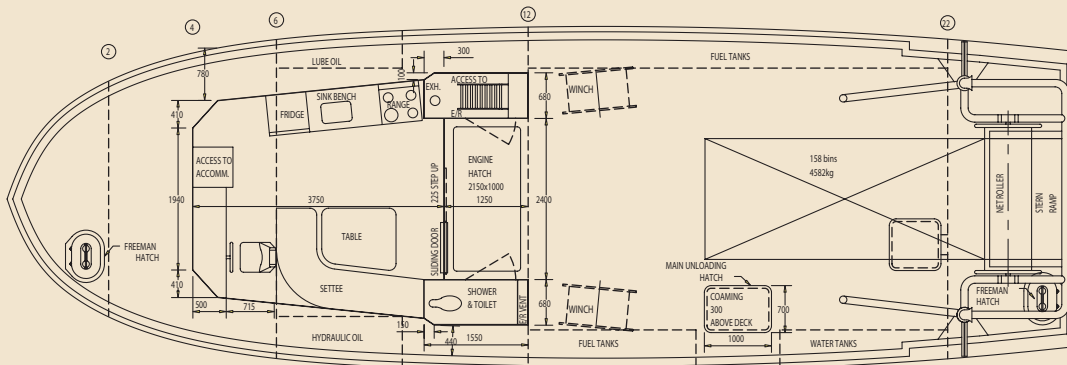

SB-ST16 specifications

Principal Particulars

Length Overall	16 m
Design Water Length	15.500 m
Beam	5.100 m
Draft	2.500 m
Displacement	76.00 Tonne

Fuel Oil Capacity	8,500L approx.
Fresh Water Capacity	2,000L approx.
Fish Hold Capacity	42 cubic metres approx.
Free Running Speed	9 knots approx.

Main Engine	Cummins NTA-855-M, 330bhp Diesel Engine
Gearbox	Twindisc MC-5111 Deep Case Marine Transmission
Propeller	Glough Bros 4 bladed 43" x 43", through a steerable nozzle
Bollard Pull	approx. 4700 kg
Mains Power Supply	17.5kva Hydraulically Driven Alternator
Trawl Winches	SBL Hydraulic split winches, computer controlled with auto scrolling 1200m x 13mm wire per winch
Refrigeration	Salt Water Ice Maker and Cold Wall Refrigeration Pipes

General Information continued...

While a number of changes are possible to the layout and equipment fitted to the FT Cressy, the basic vessel has proven to be a winner for the Skipper / Crew and Vessel Owner — so why change a winning formula?

The trawler is well suited to existing industry participants who perhaps operate two "traditional 50ft vessels". It is believed that the SB-ST16 concept would enable you to operate with just one vessel, thus providing immediate benefits through reduced fuel, vessel maintenance, crew, and a host of other operating expenditures.

Likewise any operator looking to catch more, at less cost, with more comfort should look to upgrade to a vessel like this

Design Description

Construction

The vessel is constructed to full survey approval.

The hull shall be of welded steel construction following the conventional system of transverse framing with square transom and double chine.

Propulsion

The vessel is designed with a single 330 HP engine running a Twindisc MC-5111 Deep Case Marine Transmission to a 4 bladed 43" x 43" fixed propeller in a steerable nozzle.

The Engine drives PTO mounted hydraulic pumps for the hydraulic systems including the 17.5kva alternator.

The Engine and Propulsion package can be varied to suit owner's requirements.

Controls

Full engine instrumentation/controls will be installed.

Trawl Winches

2 x Hydraulic Split Trawl Winches with scrolling gear and wire counters fitted.

Full proportional joystick control for each winch, and full auto function via computer for shooting/hauling and adjusting wire out during fishing operations.

Accommodation

4 single berths will be provided for in the forward lower accommodation space.

A single WC and Shower will also be fitted aft at Wheelhouse Deck Level.

Galley

Sink with Hot & Cold Water, Oven, Hobs, Fridge and Microwave.

Electronics

Radar, VHF, SSB, Echo Sounder, GPS, Cellphone, Auto Pilot, Computer, TV/Video/DVD, CD/Radio.

Safety Equipment

- Fire Extinguishers
- Lifejackets
- Liferaft
- EPIRB, etc. to survey

Price

Price on Request

11 Cyrus Williams Quay, PO Box 144, Lyttelton, New Zealand
Ph: +64 3 328-8550, Fax: +64 3 328-8791, Email: info@starkbros.co.nz

www.starkbros.co.nz

